

Wire	Circuits
YELLOW	- left direction indicator
BLACK	- reverse lamps and reverse alarm
WHITE	- earth return
GREEN	- right direction indicator
BLUE	- warning beacon
RED	- stop lamps
BROWN	- park/clearance lamps
PURPLE	- left work lamp
ORANGE	- right work lamp

Notes: 1. Only connect work lamp circuits if work lamps are fitted.
2. Each circuit should be protected by a fuse.

Included Hardware



30mm T bolts (2)



flat washers (2)



spring washers (2)



nyloc nuts (2)

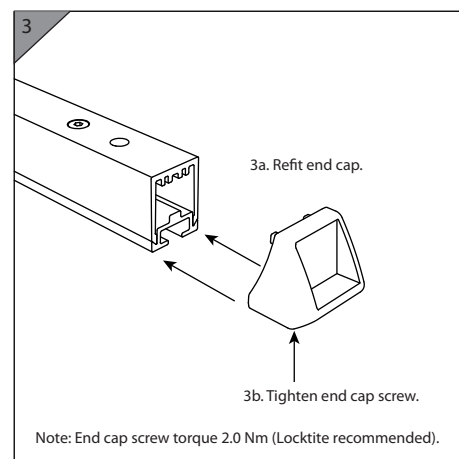
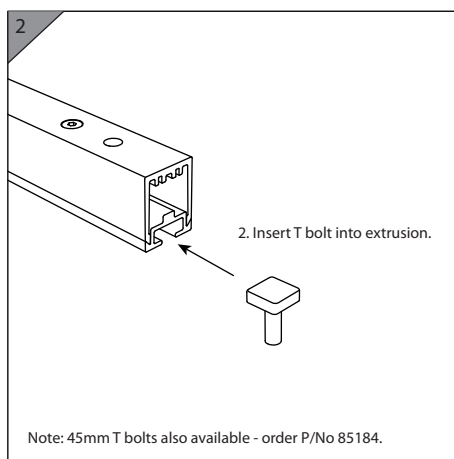
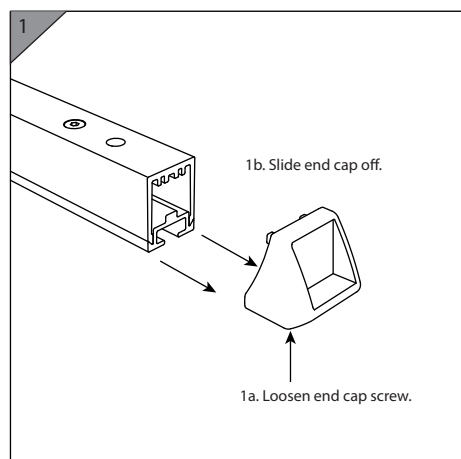

ROPS mounting

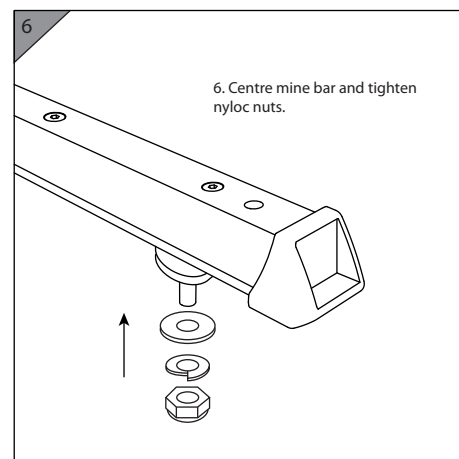
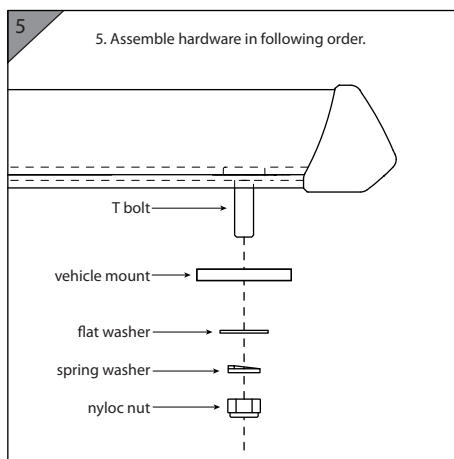
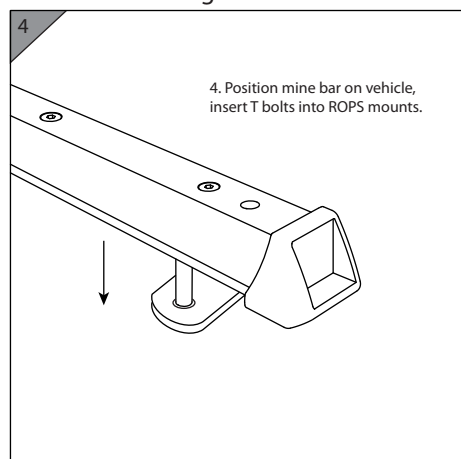

Rhino rack mounting (Rhino adaptor kit required - order Narva P/No 85186; Rhino mount not included)

Note: Not compatible with Heavy Duty Rhino CXB series system.

